



ADDENDUM NO. 02

DATE: March 17, 2023

CONTRACT NO.: ES-0043-C02

PROJECT: Orange - Cleveland Street Elementary School – Addition and Renovation

This addendum shall be considered part of the Bid Documents issued in connection with the referenced project. Should information conflict with the Bid Documents, this Addendum shall supersede the relevant information in the Bid Documents.

A. CHANGES TO THE PROCUREMENT PROCESS:

1. Modifications to the Advertisement and Associated Documents

(Not applicable)

B. CHANGES TO VOLUME 1 OF THE PROJECT MANUAL

- 1. REPLACE:** The Project Manual Table of Contents issued for bid dated 01/30/2023 shall be deleted and replaced with the Project Manual Table of Contents dated 03/10/2023 issued herewith as Attachment 2.01.
- 2. DELETE:** Division 1 Specification Section 01323 (Photographic Documentation) is deleted.

C. CHANGES TO VOLUME 2 OF THE PROJECT MANUAL

- 1. REPLACE:** The Project Manual Table of Contents issued for bid dated 01/30/2023 shall be deleted and replaced with the Project Manual Table of Contents dated 03/10/2023 issued herewith as Attachment 2.01.
- 2. Modification to the Technical Specifications**
 - a. MODIFY:** Project Manual Technical Specification Section 098000 Room Acoustical Treatment, shall be modified to revise the title of the section as follows:
SECTION 098000 – ~~ROOM~~ ACOUSTICAL TREATMENT

D. CHANGES TO THE DRAWINGS

1. **REPLACE:** The following drawings issued for bid dated 01/20/2023 and/or issued with Addendum 1 dated 02/23/2023 shall be deleted and replaced with the following revised drawings dated 03/10/2023, issued herewith as Attachment 2.02 through 2.06:

a. STRUCTURAL DRAWINGS

- i. Drawing S-2.01 Proposed Foundation Plan, revised 02/23/2023, issued with Addendum #1, shall be deleted and replaced with Drawing S-2.01 Proposed Foundation Plan, revised 03/10/2023, included herewith as Attachment 2.02.
- ii. Drawing S-3.02 Foundation Sections 2, dated 01/20/2023, issued for bid, shall be deleted and replaced with Drawing S-3.02 Foundation Sections 2, dated 03/10/2023, included herewith as Attachment 2.03.
- iii. Drawing S-3.03 Foundation Sections 3, revised 02/23/2023, issued with Addendum #1, shall be deleted and replaced with Drawing S-3.03 Foundation Sections 3, revised 03/10/2023, included herewith as Attachment 2.04.

b. ARCHITECTURAL DRAWINGS

- i. Drawing A-7.09 Enlarged Plans and Sections, dated 01/20/2023, issued for bid, shall be deleted and replaced with Drawing A-7.09 Enlarged Plans and Sections, revised 03/10/2023, included herewith as Attachment 2.05.
- ii. Drawing A-7.10 Enlarged Plans and Sections, dated 01/20/2023, issued for bid, shall be deleted and replaced with Drawing A-7.10 Enlarged Plans and Sections, revised 03/10/2023, included herewith as Attachment 2.06.

E. BIDDER'S QUESTIONS, REQUESTS FOR INFORMATION AND RESPONSES

Bidder Question #01: Please advise if the additional site visits will be available for our subcontractors?

Response: No additional site visits will be scheduled.

Bidder Question #02: Please advise if the additional submittals will be available

Response: Submittals were provided for certain previously purchased materials to be incorporated into the Project under this contract. No other submittals issued pursuant to a prior contract will be provided.

Bidder Question #03: Drawing S-2.01 referring to det. S2/S-3.02. Det. S2 is missing. Please provide.

Response: See revised Structural Drawings S-2.01 and S-3.02 issued herewith as Attachments 2.03 and 2.04.

- Bidder Question #04:** Det. 2 & 3/A7.10 showing existing lobby stair footing & foundation to remain, det. S5/S-3.03 showing new footing & foundation for lobby stair. Please clarify.
- Response:** See revised Structural Drawing S-3.03 and revised Architectural Drawing A7.10 issued herewith as Attachments 2.05 and 2.07
- Bidder Question #05:** Drawing A9.06 is not showing Basis of Design of classrooms & office millwork. Should BOD be “Hamilton Sorter” or “Dwyer Prodct”? Please clarify.
- Response:** The basis of design is Hamilton Sorter. Refer to Section 125110 of the project manual for details.
- Bidder Question #06:** Specification Section 01323 Photographic Documentation is included in the document set, however the entire specification section is crossed out. Please confirm if this spec is applicable to the project, and if so, please re-issue a clean copy of this spec.
- Response:** The cited Specification is not applicable to this project and has been deleted, per Section B.2 of this Addendum. See also revised Project Manual Table of Contents dated 03/10/2023 issued herewith as Attachment 2.01.
- Bidder Question #07:** Specification Section 01411 HVAC Test & Balance is listed on the TOC as intentionally omitted and this spec is not included in the document set. Please confirm this spec does not apply to this project.
- Response:** Confirmed. For testing and balancing requirements for the Project, refer to the Project Manual Technical Specification Section 230593 Testing, Adjusting and Balancing for HVAC. See also revised Project Manual Table of Contents dated 03/10/2023, issued herewith as Attachment 2.01.
- Bidder Question #08:** Specification Section 080671 is listed on the TOC as Door Hardware Sets, however the actual spec description is Door Hardware Schedule. Please update the TOC accordingly.
- Response:** See revised Project Manual Table of Contents dated 03/10/2023, issued herewith as Attachment 2.01.
- Bidder Question #09:** Specification Section 098000 is listed on the TOC as Acoustic Treatment, however the actual spec description is Room Acoustic Treatment. Please update the TOC accordingly.
- Response:** See revised Project Manual Table of Contents dated 03/10/2023 issued herewith as Attachment 2.01.

Bidder Question #10: Specification Section 237414 Packaged RTU Acoustical Enclosure is included in the document set, but it is not listed on the TOC. Please update the TOC accordingly.

Response: See revised Project Manual Table of Contents dated 03/10/2023 issued herewith as Attachments 2.01.

Bidder Question #11: Specification Section 237434 Packaged DOAS Noise Control is included in the document set, but it is not listed on the TOC. Please update the TOC accordingly.

Response: See revised Project Manual Table of Contents dated 03/10/2023 issued herewith as Attachment 2.01.

Bidder Question #12: Specification Section 263214 is listed on the TOC as Generator Load Bank, however actual spec description is Outdoor Resistive Load Bank. Please update the TOC accordingly.

Response: See revised Project Manual Table of Contents dated 03/10/2023 issued herewith as Attachment 2.01.

Bidder Question #13: Specification Section 265600 Exterior Lighting is listed on the TOC, however the actual specification section included in the document set is 265619 LED Exterior Lighting. Please update the TOC accordingly.

Response: See revised Project Manual Table of Contents dated 03/10/2023 issued herewith as Attachment 2.01.

Bidder Question # 14 We have been informed Item 3 – Signature Server Milk Station 37001 has been discontinued. Please provide another model as Vollrath does not have a replacement unit.

Response: Bidders shall utilize Avantco Refrigeration MC58-HC 58” School Milk Cooler as the basis of design.

Bidder Question # 15 We are requesting the extension to the RFI’s due date, because we didn’t get the plans too long ago. The reason was the SDA website had the wrong email address so we couldn’t obtain the documents on time

Response: The request is denied.

Bidder Question # 16 Please confirm only one proposal is to be submitted.

Response: SDA interprets this question to seek confirmation that this procurement does not require the submission of a Technical Proposal. No Technical Proposal is required to be submitted for

this procurement. See Section 4.1C of the Instructions to Bidders for details regarding the Price Proposal and related documents required to be submitted.

Bidder Question # 17

On Page 14 of the ITB it states, “SBE/DVOB Participation Form for the Bidder and its subcontractors along with an updated Confirmation Statement of SBE/DVOB status,,,,” Please clarify if the SBE/DVOB Participation Form and Confirmation Statement of SBE/DVOB status are to be submitted with the Price Proposal documents.

Response:

The SBE/DVOB Participation form and the SBE/DVOB Confirmation Statement are required to be submitted by the successful bidder upon receipt of the Notice of Intent to Award letter; they are not due at submission of the Price Proposal.

Bidder Question # 18

Please confirm that Exhibit B does not have to be provided with the Price Proposal or the signed Contract.

Response

Not confirmed. The Exhibit B documents must be submitted prior to contract award, but are not required to be submitted with the Price Proposal.

Bidder Question # 19

Please confirm is a consent of surety is required with the Price Proposal.

Responses

A Consent of Surety is to be submitted with the bid bond, which is due at the time of submission of the Price Proposal.

Bidder Question # 20

Please confirm if a consent of surety form will be provided.

Response

NJSDA does not provide Consent of Surety forms. Bidders should contact their bonding companies to secure such forms.

Bidder Question # 21

Please confirm that the final proposal consists of the Price Proposal, Bid Bond, Ownership Disclosure Form, and the Contractor and Subcontractors’ Business Documents.

Response

Please refer to section 4.1C of the Instructions to Bidders for the documents that are required for a responsive submission. See also the Response to Bidder Question # 16.

Bidder Question # 22

Clarify if the AISC certification is required by the structural steel subcontractor.

Response

The Structural Steel contractor for the Project is required to hold an AISC Certification.

Bidder Question # 23	Please provide a contact list of previously contracted Subcontractors involved on the project.
Response	The request is denied.
Bidder Question # 24	Please provide the final report of the Constructability Review.
Response	SDA interprets this request to refer to a Constructability Review conducted as part of a prior contract. The request is denied.
Bidder Question # 25	Please confirm there is no new Constructability Review required for this project.
Response	Confirmed, the Contract that is the subject of this procurement does not include a Constructability Review.
Bidder Question # 26	Please provide approved coordination drawings previously prepared and approved for the project.
Response	SDA interprets this request to refer to coordination drawings produced by a prior contractor as part of a prior contract. The request is denied.
Bidder Question # 27	Please identify any and all items already fully approved (by submittal) preferable via a submittal log.
Response	Certain submittals relating to previously-purchased materials to be incorporated into the Project have been provided, no other submittals from a prior contract will be provided.
Bidder Question # 28	Given the short duration, require submittal cycle(s) and fabrication of long-lead items may prove an unforeseen timing challenge How will this be addressed by the SDA should it be encountered?
Response	Bidders should prepare their bids to meet the contractual duration specified in the Contract Documents, and should factor into their calculations the conditions identified in the question.
Bidder Question # 29	Please provide assessment of the quality/usability of all materials stored on or off-site and firm whether they are suitable for installation.
Response	All previously purchased materials listed in the documents as intended for incorporation into the Project are stored on-site and have been approved by the SDA's Design Consultant for installation and incorporation into the Project. There are no materials stored off site.

Bidder Question # 30 Please provide approved structural shoring plans for the existing shoring in place.

Response Approved shoring plans for the existing shoring will be provided to the successful bidder.

Bidder Question # 31 Please confirm that there are no other permits to be obtained by the GC beyond those listed in the bid documents.

Response The only permits obtained are those listed in the bid documents; all other permits required by code must be obtained by the successful bidder.

Bidder Question # 32 Please identify locations of GC staging and parking.

Response The awardee is responsible to identify such locations based upon the information provided in the bid documents.

Bidder Question # 33 Has the suitability of existing soil under paved conditions been tested and verified on the previous contract? Please provide soil sampling test locations and lab results, inclusive of the structural and environment findings.

Response Soils under paved conditions have not been tested and the NJSDA has included Allowance 2 Impacted and Unsuitable Material Allowance to address any unsuitable material encountered during construction activities.

Bidder Question # 34 As the school is adjacent to residential, are there limited hours to work during the week and/or weekends?

Response Bidders are advised to refer to applicable local ordinances for potential restrictions on construction working hours.

Bidder Question # 35 How will warranties of previously purchased materials or previously completed installations be addressed? If extensions of warranted periods are required, at cost who will be responsible?

Response The winning bidder will be responsible for securing warranties on materials and equipment it provides, in accordance with the Contract Documents and for extending the warranties of previously purchased materials or previously completed installations on the Project, per the Contract Documents Accordingly, Bidders shall include within their Price Proposals all costs for extending existing warranties and guarantees, in addition to the costs for securing required warranties on new materials to be provided by the winning Bidder, for all material and equipment installed on the project, whether such material has been previously purchased or is to be provided by the awardee in compliance with

the terms and conditions of the contract documents. See paragraph 3.2.A in Section 01010 Summary of Work.

Bidder Questions # 36

Items on site previously purchased or proprietary: keying, windows, elevator, roofing, electrical equipment, generator, clock and speaker system. Shouldn't these items be taken over as the Owner supplied and therefore hold the warranties should there be issues during installation related to their functionality. Some of these items have significant lead times that they will need to be verified by successful subcontractor upon NTP before taking ownership.

Response

See Response to Bidder Questions #28 and #35.

F. CHANGES TO PREVIOUS ADDENDA:

(Not applicable)

G. ATTACHMENTS:

Attachment 2.01 Project Manual Table of Contents, Revised 03/10/2023

Attachment 2.02 Drawing S-2.01 Proposed Foundation Plan Dated 3/10/2023

Attachment 2.03 Drawing S-3.02 Foundation Sections 2 Dated 3/10/2023

Attachment 2.04 Drawing S-3.03 Foundation Sections 3 Dated 3/10/2023

Attachment 2.05 Drawing A.7.09 Enlarged Plans and Sections Dated 3/10/2023

Attachment 2.06 Drawing A7.10 Enlarged Plans and Sections Dated 3/10/2023

H. SUPPLEMENTAL INFORMATION

(Not applicable)

Any bidder attempting to contact government officials (elected or appointed), including NJSDA Board members, NJSDA Staff (except for Procurement), Selection Committee members, NJSDA Consultants, and School District officials for information relating to this project or in an effort to influence the selection process may be immediately disqualified.

End of Addendum No. 02



ADDENDUM NO. 02

DATE: **March 17, 2023**

CONTRACT NO.: **ES-0043-C02**

PROJECT: **Orange – Cleveland Street Elementary School – Addition and Renovation**

Acknowledgement of Receipt of Addendum

Contractor must acknowledge the receipt of the Addendum by signing in the space provided below and returning via email to Alison Perry at aperry@njsda.gov. Signed acknowledgement must be received prior to the Bid Due Date. Acknowledgement of the Addendum must be made in **Section F.5** of the Price Proposal Submission.

Signature

Print Name

Company Name

Date

TABLE OF CONTENTS

TABLE OF CONTENTS	(TC)
BID ADVERTISEMENT	(AD)
INSTRUCTIONS TO BIDDERS.....	(IB)
PROJECT RATING PROPOSAL.....	(PRP)
PRICE PROPOSAL	(PP)
OWNERSHIP DISCLOSURE FORM	(ODF)
STATEMENT OF JOINT VENTURE.....	(JV)
NJSDA TOTAL AMOUNT OF UNCOMPLETED CONTRACTS FORM.....	(UC)
BID BOND FORM	(BB)
SAMPLE OF FORMS TO BE COMPLETED UPON EXECUTION OF CONTRACT	(SF)
FORM OF CONTRACT	(FC)
PERFORMANCE BOND FORM.....	(FB)
PAYMENT BOND FORM	(PB)
SBE/DVOB PARTICIPATION FORM.....	(S/DPF)
CONFIRMATION STATEMENT of SBE/DVOB STATUS FORM.....	(CS)
OCIP IV – OWNER’S CONTROLLED INSURANCE PROGRAM MANUAL	(OCIP)
SUBCONTRACTOR APPROVAL FORM	(1105)
AA-201 INITIAL PROJECT WORKFORCE REPORT.....	(AA)
AA-201a SUBCONTRACTOR PROJECTION FORM.....	(AAa)
TWO-YEAR CHAPTER 51/EXECUTIVE ORDER 117 - VENDOR CERTIFICATION AND DISCLOSURE OF POLITICAL CONTRIBUTIONS	(CH51)
DISCLOSURE OF INVESTMENT ACTIVITIES IN IRAN.....	(DIAI)
CERTIFICATION OF NON-DEBARMENT FORM.....	(CND)
CERTIFICATION OF NON-INVOLVEMENT IN PROHIBITED ACTIVITIES IN RUSSIA OR BELARUS.....	(CPARB)
FORM W-9 REQUEST FOR TAXPAYER IDENTIFICATION NUMBER AND CERTIFICATION.....	(W-9)
EFT AUTHORIZATION FORM	(EFT)
CODE OF ETHICS FOR VENDORS.....	(CE)

QUALITY ASSURANCE/QUALITY CONTROL MANUAL FOR CONTRACT WORK.....(QAQC)

SAFETY MANUAL.(SM)

NJ PREVAILING WAGE RATES(NJPW)

PROJECT LABOR AGREEMENT (signature page & letter of assent)(PLA)

GENERAL CONDITIONS(GC)

Article	1	Definitions
Article	2	Interpretation and Intent
Article	3	The Authority’s Responsibilities
Article	4	Contractor’s Responsibilities
Article	5	Time, Project Schedule and Progress
Article	6	Prosecution and Progress of the Work
Article	7	Subcontractors
Article	8	Changes in the Work
Article	9	Bonds and Insurance
Article	10	Suspension of the Work
Article	11	Default and Termination
Article	12	Substantial Completion and Final Completion
Article	13	Payment and Contract Completion
Article	14	Protection of Persons and Property
Article	15	Documents and Records
Article	16	Risk of Loss and Indemnification
Article	17	Claims
Article	18	Affirmative Action and Non-Discrimination
Article	19	Warranties
Article	20	Solid Waste, Hazardous Waste, Underground Storage Tanks, and Asbestos Transportation and Disposal
Article	21	Legal Relations and Additional Provisions

DRAWING LIST(DL)

SPECIFICATIONS

DIVISION 1 – GENERAL REQUIREMENTS

01010 Summary of the Work.....	01010
01020 Allowances.....	01020
01050 Field Engineering.....	01050
01080 Change Order Procedure.....	01080
01100 Coordination.....	01100
01130 Cutting & Patching.....	01130
01200 Preconstruction Conference.....	01200
01220 Project Meetings.....	01220
01300 Submittals.....	01300

01310 Schedules and Reports	01310
01323 Photographic Documentation (<i>intentionally omitted</i>)	01323
01410 Testing Laboratory Service	01410
01411 HVAC Test & Balance (<i>intentionally omitted</i>)	01411
01500 Temporary Facilities	01500
01520 Storage and Protection	01520
01600 Products & Substitutions	01600
01700 Contract Closeout	01700
01810 Project Record Documents	01810
01820 Operating & Maintenance Data	01820
01850 Warranties & Bonds	01850
01900 Commissioning	01900

SUPPLEMENTARY REQUIREMENTS (See Attachments)

Att. 1.01 Stored Materials Photo Documentation

Att. 1.02 Stored Materials Product Data

Att. 1.03 As-Built Conditions at Cleveland Street Elementary School

Att. 1.04 Existing As-Built Conditions Photo Documentation

VOLUME 2

TECHNICAL SPECIFICATIONS: DIVISIONS 2 – 23

DIVISION 2 – EXISTING CONDITIONS

024119 Demolition

DIVISION 3 – CONCRETE

033000 Cast-in-Place Concrete

034900 Glass Fiber Reinforced Concrete

DIVISION 4 – MASONRY

042200 Concrete Unit Masonry

042300 Reinforced Unit Masonry

045310 Cavity Wall Flashing/Drainage System

047200 Architectural Cast Stone

DIVISION 5 – METAL

050900 Metal Fastenings

051200 Structural Steel

052100 Steel Joists

053000 Acoustical Metal Deck

053100 Steel Decking

054000 Cold-Formed Metal Framing

054500 Cold-Formed Metal Roof Trusses

055050 Miscellaneous Structural Fabrications

055100 Metal Stairs and Railings

055150 Fixed Vertical Ladder

055216 Egress Gate

058100 Expansion Joint Cover Assemblies

DIVISION 6 – WOOD AND PLASTICS

061000 Rough Carpentry

062000 Finish Carpentry

DIVISION 7 – THERMAL AND MOISTURE PROTECTION

071326 Self-Adhering Sheet Waterproofing

072100 Building Insulation

072110 Rigid Foam Board Insulation

072120 Air/Vapor Barrier Membrane System

- 073100 Asphalt/Granular – Surface Dimensional Type Shingles
- 075520 EPDM Roofing System
- 076000 Flashing and Sheet Metal
- 077100 Roof Hatch
- 077200 Roof Accessories
- 077253 Snow Guards
- 078410 Firestopping and Smokestopping
- 079000 Joint Sealants
- 079010 Pre-compressed Seal Expansion Joint

DIVISION 8 – DOORS AND WINDOWS

- 080671 Door Hardware Sets ~~Sets~~ Schedule
- 081113 Hollow Metal Doors and Frames
- 081416 Flush Wood Doors
- 081613 Fiberglass Reinforced Polyester (FRP) Doors and Aluminum Frames
- 083110 Access Doors and Frames
- 084100 Aluminum-Framed Entrances and Storefronts
- 085113 Aluminum Windows
- 085810 Security Screens
- 087100 Door Hardware
- 088000 Glazing
- 088170 Fire Rated Glazing

DIVISION 9 – FINISHES

- 092530 Gypsum Sheathing
- 092600 Gypsum Board Assemblies
- 093100 Ceramic Tile
- 095120 Acoustical Tile Ceilings
- 095400 Solid Polymer Fabrications
- 096180 Sound Isolation Membranes
- 096420 Wood Stage Flooring
- 096466 Wood Athletic Flooring
- 096510 Resilient Floor Tile and Accessories
- 096520 Vinyl Wall Base
- 096530 Vinyl Stair Treads and Risers
- 096723 Resinous Epoxy Flooring
- 096810 Carpet Tile

- 098000 Acoustic Treatment
- 098400 Acoustical Wall Treatment
- 099000 Painting

DIVISION 10 – SPECIALTIES

- 101000 Visual Display Boards
- 101550 Toilet Compartments
- 102000 Louvers and Vents
- 104100 Display Cases
- 104400 Interior Signage
- 105100 Metal Lockers
- 105200 Fire-Protection Specialties
- 105400 Hanger Rod Supported Canopies
- 105613 Metal Storage Shelving
- 107000 Toilet and Bath Accessories

DIVISION 11 – EQUIPMENT

- 112600 Unit Kitchens
- 114400 Food Service Equipment
- 114800 Physical Education Equipment
- 116143 Stage Curtains
- 116800 Play Field Equipment and Structures

DIVISION 12 – FURNISHINGS

- 123450 Wood Science Casework
- 124900 Manually Operated Window Shades
- 124950 Motorized Roller Shades
- 125110 Modular Casework and Mail Room Furniture
- 125250 Privacy Curtain (Nurse’s Office)

DIVISION 13 – SPECIAL CONSTRUCTION

- 139150 Sprinkler Piping (Fire Sprinkler)
- 139160 Sprinkler Systems (Fire Sprinkler)

DIVISION 14 – CONVEYING EQUIPMENT

- 142400 Machine Room-Less Hydraulic Elevators

DIVISION 22 – PLUMBING

- 220000 Plumbing Summary of Work
- 220501 Basic Plumbing Materials and Methods
- 220517 Sleeves and Sleeve Seals for Plumbing Piping

- 220518 Escutcheons for Plumbing Piping
- 220519 Meters and Gages for Plumbing Piping
- 220523 Valves
- 220529 Hangers and Supports for Plumbing Piping and Equipment
- 220548 Vibration and Seismic Controls
- 220553 Identification for Plumbing Piping and Equipment
- 220719 Plumbing Piping Insulation
- 221113 Facility Water Distribution Piping
- 221116 Domestic Water Piping
- 221119 Domestic Water Piping Specialties
- 221123 Facility Natural-Gas Piping
- 221313 Sanitary Sewer Structures
- 221316 Sanitary Waste and Vent Piping
- 221317 Ductile Iron Sanitary Sewer Pipe
- 221319 Sanitary Waste Piping Specialties
- 221323 Sanitary Waste Interceptors
- 221413 Facility Storm Drainage Piping
- 221423 Storm Drainage Piping Specialties
- 223400 Fuel-Fired Domestic-Water Heater
- 224213 Plumbing Fixtures

DIVISION 23 – HEATING, VENTILATING AND AIR CONDITIONING

- 230000 Mechanical Summary of Work
- 230500 Common Work Results for HVAC
- 230513 Common Motor Requirements for HVAC Equipment
- 230519 Meters and Gages for HVAC Piping
- 230523 General-Duty Valves for HVAC Piping
- 230529 Hangers and Supports for HVAC Piping and Equipment
- 230548 Mechanical Vibration and Seismic Controls
- 230553 Mechanical Identification
- 230593 Testing, Adjusting, and Balancing for HVAC
- 230713 Duct Insulation
- 230714 Acoustic Duct Insulation
- 230719 HVAC Piping Insulation
- 230923 Direct-Digital Control System for HVAC
- 230993 Sequence of Operations for HVAC Controls

- 232113 Hydronic Piping
- 232123 Hydronic Pumps
- 232300 Refrigerant Piping
- 233113 Metal Ducts
- 233300 Air Duct Accessories
- 233416 HVAC Centrifugal Fans
- 233713 Diffusers, Registers, and Grilles
- 235100 Breeching, Chimneys, and Stacks
- 235216 Condensing Boilers
- 236423 Scroll Water Chillers
- 237313 Modular Indoor Central-Station Air-Handling Units
- 237413 Packaged Rooftop HVAC Units
- 237414 Packaged Rooftop Unit Acoustical Enclosure**
- 237433 Dedicated Outdoor-Air Units
- 237434 Packaged DOAS Noise Control**
- 238126 Split-System Air-Conditioners
- 238238 Cabinet Unit Heaters
- 238239 Propeller Unit Heaters

DIVISION 26 – ELECTRICAL

- 260500 Basic Electrical Materials and Methods
- 260501 Electrical – General
- 260519 Conductors and Cables
- 260526 Grounding and Bonding
- 260529 Hangers and Supports for Electrical Systems
- 260534 Raceways and Boxes
- 260536 Cable Trays for Electrical Systems
- 260543 Underground Ducts and Raceways for Electrical Systems
- 260544 Sleeves and Sleeve Seals for Electrical Raceways and Cabling
- 260548 Seismic Controls for Electrical Systems
- 260553 Electrical Identification
- 260573 Overcurrent Protective Device Coordination
- 260800 Electrical Systems Commissioning
- 260923 Lighting Control Devices
- 260936 Modular Lighting Controls
- 260943 Network Lighting Controls

- 262200 Transformers
- 262413 Switchboards
- 262416 Panelboards
- 262713 Electricity Metering
- 262726 Wiring Devices
- 262813 Fuses
- 262816 Enclosed Switches and Circuit Breakers
- 262923 Variable-Frequency Motor Controllers
- 263213 Packaged Engine Generators
- 263214 ~~Generator~~ **Outdoor Resistive** Load Bank
- 263600 Transfer Switches
- 264113 Lightning Protection System
- 264313 Surge Protection Device
- 265100 Interior Lighting
- 265119 LED Interior Lighting
- 265561 Theatrical Lighting
- 265600 **19 LED** Exterior Lighting

DIVISION 27 – COMMUNICATIONS

- 270000 Communications
- 270500 Common Work Results for Communications
- 270526 Grounding and Bonding for Communications Systems Specification
- 270528 Pathways for Communications Systems
- 271100 Communications Equipment Rooms and Fittings
- 271300 Communications Backbone Cabling
- 271500 Communications Horizontal Cabling
- 272000 Data Communications
- 272100 Data Communications Network Equipment
- 274100 Network Based CATV Distribution Systems
- 274116 Sound System
- 274117 Integrated Audio-Video Systems and Equipment for Classrooms, Media Center and Music Room
- 275116 Public Address/Bell Schedule
- 275313 Clock Systems

DIVISION 28 – ELECTRONIC SAFETY AND SECURITY

- 280513 Conductors and Cables for Electronic Safety and Security

- 280526 Grounding and Bonding for Electronic Safety and Security
- 280528 Pathways for Electronic Safety and Security
- 281300 Security Management System Access Control
- 281600 Intrusion Detection
- 282300 Video Surveillance
- 283111 Digital, Addressable Fire-Alarm System

DIVISION 31 – EARTHWORK

- 311000 Site Clearing
- 312000 Earthwork
- 312319 Dewatering
- 312500 Soil Conservation
- 315000 Excavation Support and Protection

DIVISION 32 – EXTERIOR IMPROVEMENTS

- 321216 Bituminous Concrete Paving
- 321313 Concrete Paving
- 321316 Decorative Cement Concrete Pavement
- 321723 Pavement Markings
- 321816.13 Poured in Place Hybrid Playground Surfacing
- 323116 Welded Wire Fences and Gates
- 323119 Aluminum Ornamental Fence System
- 323223 Modular Concrete Retaining Wall
- 323300 Bollards
- 329300 Landscaping

DIVISION 33 – UTILITIES

- 330500 Common Work Results for Utilities
- 331116 Site Water Utility Distribution Piping
- 333100 Sanitary Utility Sewerage Piping
- 334100 Storm Utility Drainage Piping

END OF TABLE OF CONTENTS

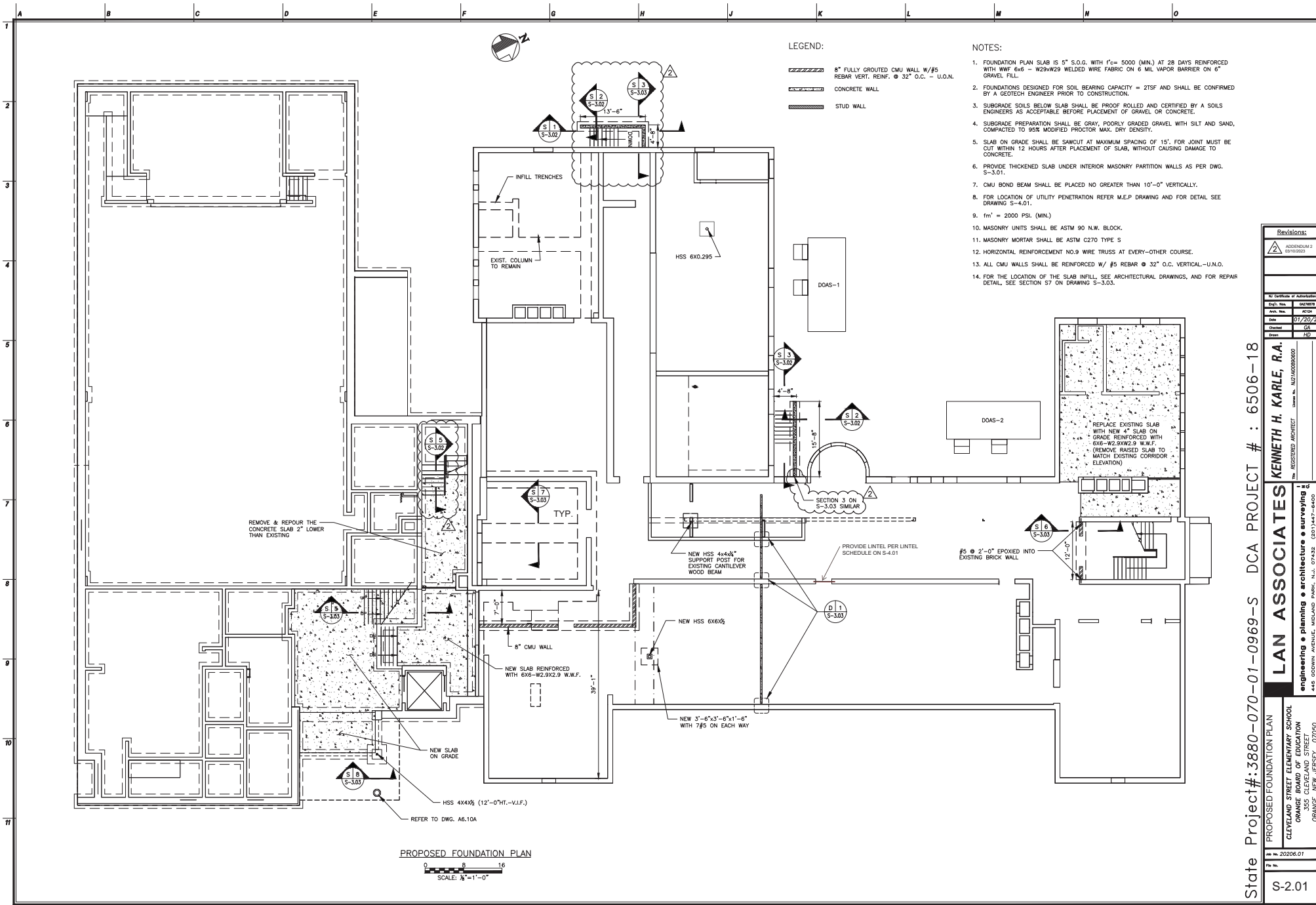

LEGEND:

- 8" FULLY GROUTED CMU WALL W/#5 REBAR VERT. REINF. @ 32" O.C. - U.O.N.
- CONCRETE WALL
- STUD WALL

NOTES:

1. FOUNDATION PLAN SLAB IS 5" S.O.G. WITH f'c= 5000 (MIN.) AT 28 DAYS REINFORCED WITH WWF 6x6 - W29xW29 WELDED WIRE FABRIC ON 6 MIL VAPOR BARRIER ON 6" GRAVEL FILL.
2. FOUNDATIONS DESIGNED FOR SOIL BEARING CAPACITY = 2TSF AND SHALL BE CONFIRMED BY A GEOTECH ENGINEER PRIOR TO CONSTRUCTION.
3. SUBGRADE SOILS BELOW SLAB SHALL BE PROOF ROLLED AND CERTIFIED BY A SOILS ENGINEER AS ACCEPTABLE BEFORE PLACEMENT OF GRAVEL OR CONCRETE.
4. SUBGRADE PREPARATION SHALL BE GRAY, POORLY GRADED GRAVEL WITH SILT AND SAND, COMPACTED TO 95% MODIFIED PROCTOR MAX. DRY DENSITY.
5. SLAB ON GRADE SHALL BE SAWCUT AT MAXIMUM SPACING OF 15'. FOR JOINT MUST BE CUT WITHIN 12 HOURS AFTER PLACEMENT OF SLAB, WITHOUT CAUSING DAMAGE TO CONCRETE.
6. PROVIDE THICKENED SLAB UNDER INTERIOR MASONRY PARTITION WALLS AS PER DWG. S-3.01.
7. CMU BOND BEAM SHALL BE PLACED NO GREATER THAN 10'-0" VERTICALLY.
8. FOR LOCATION OF UTILITY PENETRATION REFER M.E.P DRAWING AND FOR DETAIL SEE DRAWING S-4.01.
9. fm' = 2000 PSI. (MIN.)
10. MASONRY UNITS SHALL BE ASTM 90 N.W. BLOCK.
11. MASONRY MORTAR SHALL BE ASTM C270 TYPE S
12. HORIZONTAL REINFORCEMENT NO.9 WIRE TRUSS AT EVERY-OTHER COURSE.
13. ALL CMU WALLS SHALL BE REINFORCED W/ #5 REBAR @ 32" O.C. VERTICAL--U.O.
14. FOR THE LOCATION OF THE SLAB INFILL, SEE ARCHITECTURAL DRAWINGS, AND FOR REPAIR DETAIL, SEE SECTION 57 ON DRAWING S-3.03.

PROPOSED FOUNDATION PLAN

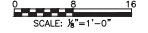

State Project #: 3880-070-01-0969-S DCA PROJECT # : 6506-18

Revisions:							
1	ADDENDUM 2 (01/20/23)						
2	ADDENDUM 1 (01/20/23)						
<table border="1" style="width: 100%; border-collapse: collapse; font-size: 8px;"> <tr> <td style="width: 20%;">No. of Submittals</td> <td style="width: 20%;">APPROVED</td> </tr> <tr> <td>By: [Signature]</td> <td>DATE: 01/20/23</td> </tr> <tr> <td>Checked: GA</td> <td>Drawn: JED</td> </tr> </table>		No. of Submittals	APPROVED	By: [Signature]	DATE: 01/20/23	Checked: GA	Drawn: JED
No. of Submittals	APPROVED						
By: [Signature]	DATE: 01/20/23						
Checked: GA	Drawn: JED						
<p>LAN ASSOCIATES KENNETH H. KARLE, R.A. engineering • planning • architecture • surveying 445 CEDWIN AVENUE, MIDLAND PARK, N.J. 07432 (201)447-6400 REGISTERED ARCHITECT License No. NJ214008000</p>							
<p>PROPOSED FOUNDATION PLAN CLEVELAND STREET ELEMENTARY SCHOOL ORANGE BOARD OF EDUCATION 5700 CLEVELAND STREET ORANGE, NEW JERSEY 07050</p>							
<p>DATE: 2020.01 DRAWN BY: [Signature] CHECKED BY: [Signature]</p>							
<p>S-2.01</p>							

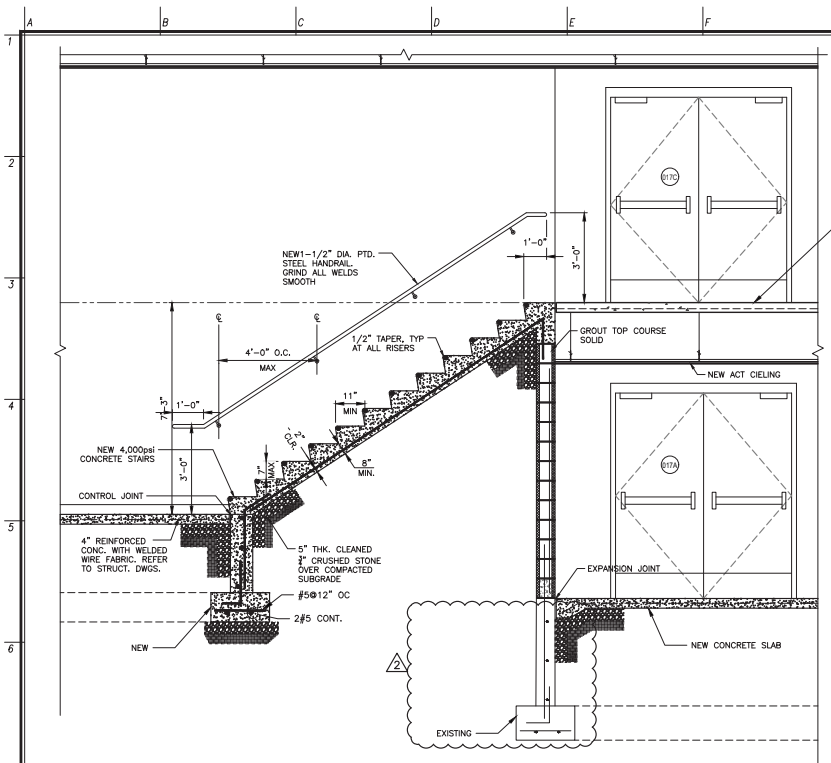

S 2 SECTION
S-200
SCALE: 1/2"=1'-0"

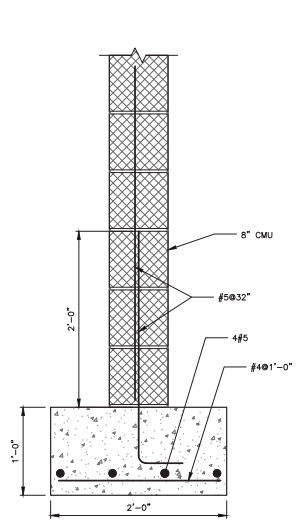

S 8 SECTION
S-201
SCALE: 1/2"=1'-0"

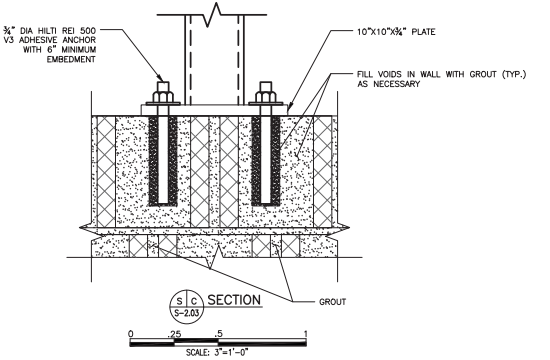

S 10 SECTION
S-200
SCALE: 3/4"=1'-0"

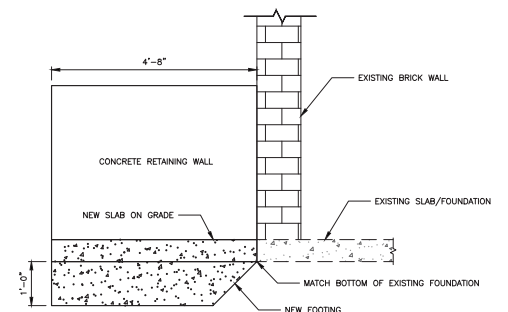

S 13 SECTION
S-201
SCALE: 3/4"=1'-0"

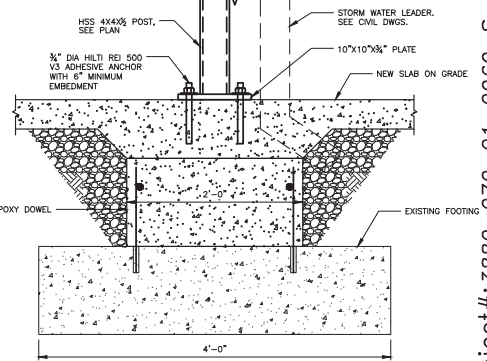

S 18 SECTION
S-201
SCALE: 1/2"=1'-0"

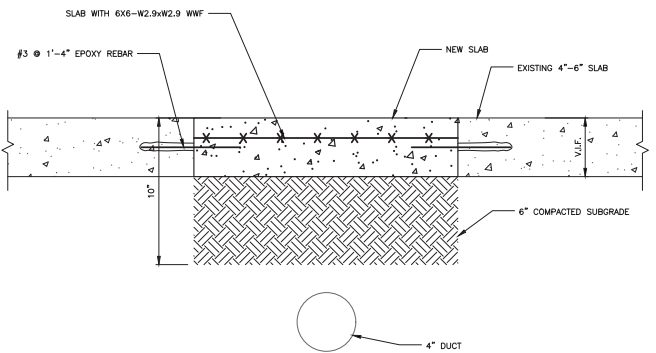

S 17 SECTION
S-201
SCALE: 3/4"=1'-0"

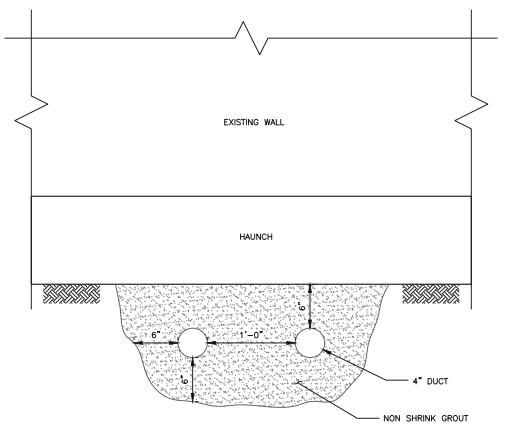

S 11 SECTION (TYP.)
S-201
SCALE: 1/2"=1'-0"

(TYP. FOR ALL TRENCH INFILLING REQUIRED FOR EXISTING AND NEW TRENCHES THROUGHOUT THE ENTIRE PROJECT)

State Project #: 3880-070-01-0969-S DCA PROJECT # : 6506-18

Revisions:	
ADDENDUM 2	03/10/23
NO Certificate of Administration	
Block No.	1
Arch. No.	ACT04
Date	07/20/23
Checked	GA
Drawn	RD

KENNETH H. KARLE, R.A.
REGISTERED ARCHITECT License No. NJZ14000000

LAN ASSOCIATES
engineering • planning • architecture • surveying • GIS
448 GORDON AVENUE, MIDLAND PARK, N.J. 07432 (908)447-8400

FOUNDATION SECTIONS 3
CLEVELAND STREET ELEMENTARY SCHOOL
ORANGE BOARD OF EDUCATION
355 CLEVELAND STREET
ORANGE, NEW JERSEY 07050

Rev. No. 20206.01
Rev. Date

S-3.03

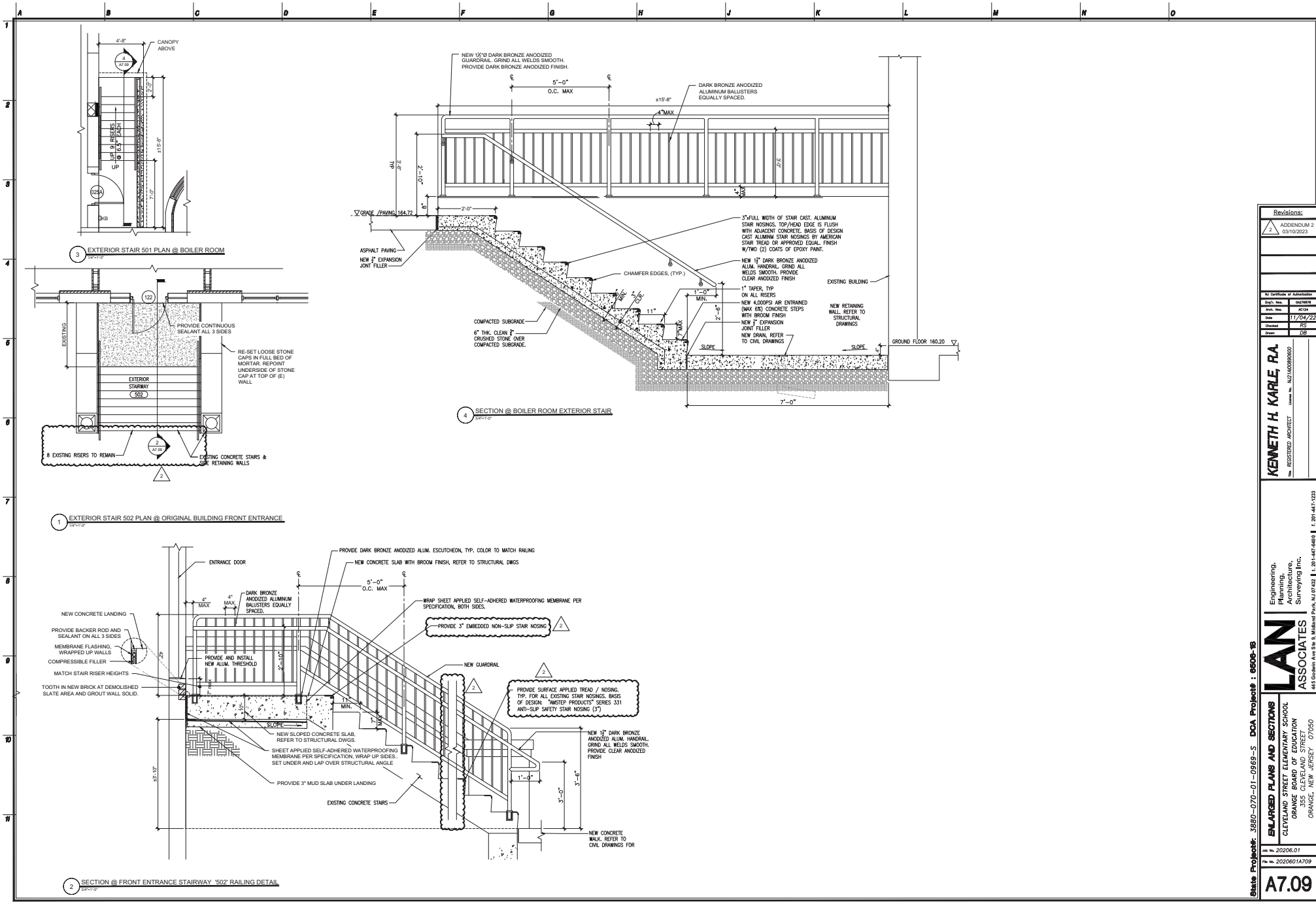

Revisions:
 2 ADDENDUM 2
 03/10/2023

No Certificate of Administration
 Draft No. 10210000
 Arch. No. A104
 Date 11/04/22
 Checked RS
 Date RB

KENNETH H. KARLE, RA
 THE REGISTERED ARCHITECT License No. NJ214000000

Scale: Project#: 3580-070-01-2959-S DCA Project#: 6500-38

ENLARGED PLANS AND SECTIONS
 CLEVELAND STREET ELEMENTARY SCHOOL
 ORANGE BOARD OF EDUCATION
 355 CLEVELAND STREET
 ORANGE, NEW JERSEY 07050

Rev. No. 20206.01
 Rev. No. 2020601A709

A7.09

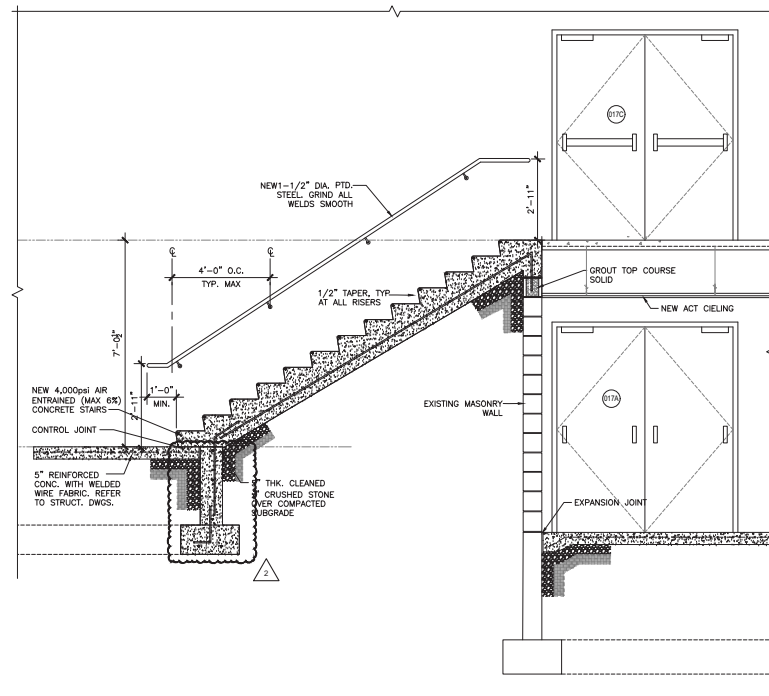
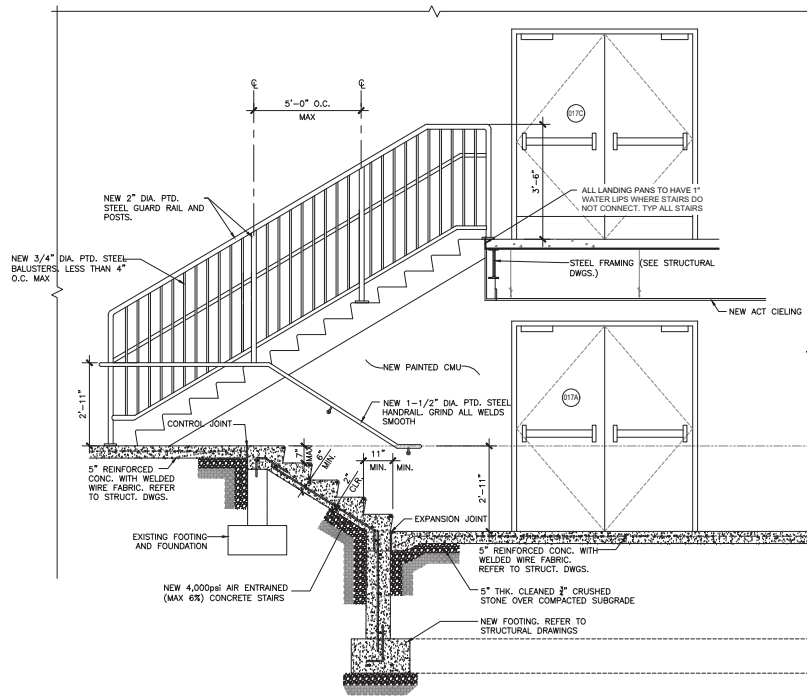
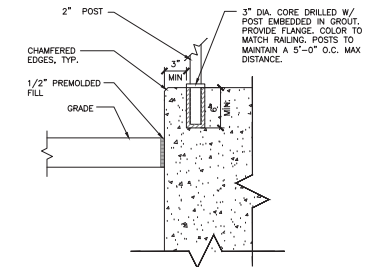
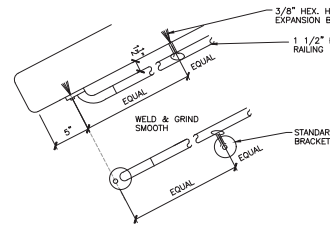
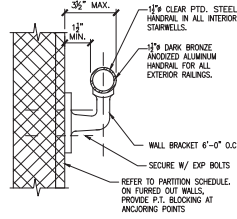
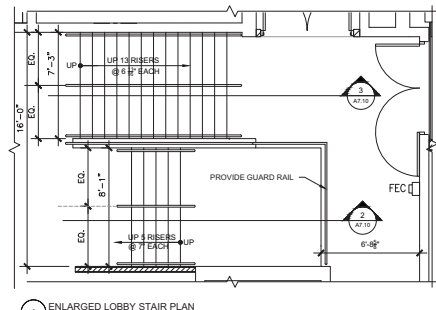

Revisions:	
2	ADDENDUM 2 03/10/2023

No. Certificate of Administration	
Arch. No.	ACT04
Date	11/04/22
Checked	RS
Drawn	FB

KENNETH H. KARLE, RA
 REGISTERED ARCHITECT License No. NJ211A00000000

Engineering, Planning, Architecture, Surveying Inc.
 445 Godwin Ave Ste 8, Millard Park, NJ 07032 | 1.201.447.1333

LAN ASSOCIATES
 Engineering, Planning, Architecture, Surveying Inc.
 CLEVELAND STREET ELEMENTARY SCHOOL
 ORANGE BOARD OF EDUCATION
 355 CLEVELAND STREET
 ORANGE, NEW JERSEY 07050

State Project: 3580-070-01-0969-S DCA Project#: 6600-18
 No. 20206.01
 No. 2020601A710

A7.10