

Prepared by the New Jersey Schools Development Authority

SDA Capital Program Report 2012 Advancement Portfolio

SDA Capital Program
2012 Advancement Portfolio

Section 1:
2011 Project Portfolio Update

Goals of the SDA 2011 Capital Program

1. Pursue Standardization

2. Advance 10 Identified Projects

- Elizabeth - Academic Magnet High School
- Long Branch - Catrambone Elementary School (Elberon)
- Bridgeton – Cherry Street Elementary School
- Jersey City – PS 20 Elementary School
- Jersey City – Elementary School 3
- New Brunswick – A. Chester Redshaw Elementary School
- Newark – Oliver Street Elementary School
- Paterson – Marshall & Hazel Elementary School
- Paterson – PS Number 16 Elementary School
- West New York – Harry L. Bain Elementary School

Standardization

- For the first time in the Authority's existence, Materials and System Standards have been developed and were published in September, 2011. These Materials and Systems Standards will be implemented on all SDA managed School Facilities Projects.
 - The SDA has published standards for the following:

❖ Below Grade Waterproofing (Foundations)	❖ Lighting (Site)
❖ Ceiling (Interior Finishes)	❖ Parking (Site)
❖ Curbs (Site)	❖ Pavements (Site)
❖ Doors (Exterior Vertical Enclosure)	❖ Railings (Site)
❖ Drop Off Areas (Site)	❖ Roof (Horizontal Vertical Enclosure)
❖ Exterior Walls (Exterior Vertical Enclosure)	❖ Utilities (Site)
❖ Fencing & Gates(Site)	❖ Wall Systems (Interior Partitions)
❖ Floor System (Interior Finishes)	❖ Windows (Exterior Vertical Enclosure)
- The SDA has also created an in-house Design Studio to develop a Kit of Parts Design
 - The Design Studio has developed model educational programs and prototypical school designs, comprised of standardized component elements, which can be rearranged to respond to varying site and other conditions for multiple Capital Program projects.

Kit of Parts Design

Application to multiple 2011 Portfolio Candidate Projects

New Brunswick – A. Chester Redshaw Elementary School



Paterson – PS 16



Jersey City – Elementary School 3

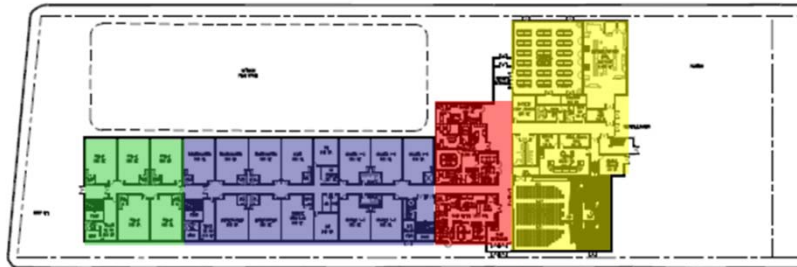

Bridgeton Project

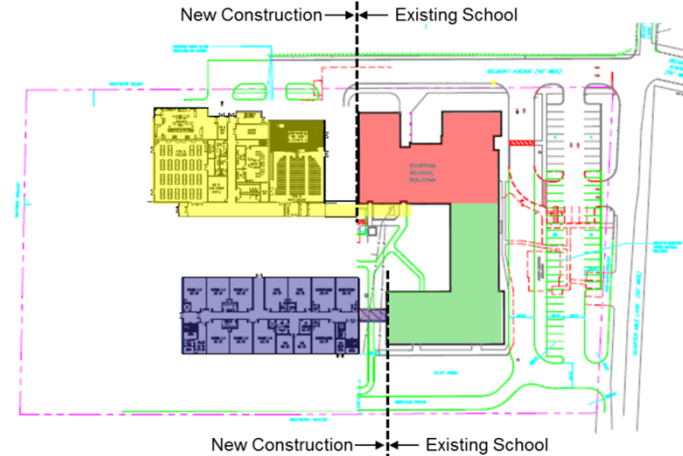

- Instructional Component
- Large Group Component
- Core Component
- PK Component

Status of the 2011 Portfolio Projects

District	Project	Grade Alignment	Capacity	Total Estimated Cost (millions)	Design Status	Advancement Status	Projected Construction Advertisement Date*
Elizabeth	Academic HS	9-12	1,091	\$81.5	Existing Design	Bids Received for Phase 1 Early Site Package Advancing to the March Board for Approval Final Preparation for Phase 2 Construction Procurement.	12/8/2011
Long Branch	Catrambone ES	PK-5	817	\$40.2	Existing Design	Advertised for Building Construction	12/20/2011
Bridgeton	Cherry St. ES	K-8	591	TBD	TBD	Scoping Conversations with Working Group (DOE/SDA/District).	TBD
Jersey City	ES 3	PK-5	814	\$67.3	Kit of Parts Candidate	Site Investigations ongoing. Design Development.	2 QTR 12
Jersey City	PS 20	K-5	628	\$54.6	Existing Design	Site Investigations ongoing. Design Development.	2 QTR 12
New Brunswick	Redshaw ES	K-5	670	\$49.3	Kit of Parts Candidate	Site Investigations ongoing. Design Development.	2 QTR 12
Newark	Oliver St. ES	TBD	TBD	TBD	Kit of Parts Candidate	Site Investigations ongoing. Design Development.	2 QTR 12
Paterson	Marshall St. ES	K-8	650	\$42.5	Existing Design	Site Investigations ongoing.	2 QTR 12
Paterson	PS 16	PK-8	651	\$61.7	Kit of Parts Candidate	Site Investigations ongoing. Land acquisition and related activities ongoing. Design Development.	1 QTR 12
West New York	Harry L. Bain PS 6	PK-6	736	TBD	TBD	Scoping Conversations with Working Group (DOE/SDA/District). Design Development for demolition of existing structure on SDA owned site.	1 QTR 12

*PLEASE NOTE - Projected Construction Advertisement Date reflects the first construction activity for the Project. Dates in the Past are ACTUAL.

SDA Capital Program 2012 Advancement Portfolio

Section 2: 2012 Project Portfolio

SDA Selects 20 Projects/Districts for advancement in 2012

1. Projects addressing high educational priority needs (Total Estimated Value based upon 2010 Reassessment \$675M):
 - Gloucester City Middle School
 - Keansburg Caruso Elementary School
 - New Brunswick Paul Robeson Community Elementary School
 - Newark Elliott Street Elementary School
 - Newark South Street Elementary School
 - Passaic Dayton Avenue Elementary School Campus
 - Phillipsburg High School
 - West New York Memorial High School

2. Projects addressing high educational priority needs that require further discussion with the District:
 - Elizabeth Elementary School grade level
 - Garfield Elementary School grade level
 - Harrison Middle School grade level
 - Millville High School grade level
 - Paterson Elementary School grade level
 - Perth Amboy all grade levels
 - Union City Elementary School grade level

3. Projects that address serious facility deficiencies:
 - Camden High School
 - Hoboken Thomas G. Connors Elementary School
 - Orange Cleveland Elementary School
 - Orange High School
 - Trenton Central High School

2012 Selection Process

1. Projects addressing high educational priority needs

The results of the 2011 Statewide Prioritization provided the ranking of projects for educational need and efficient construction and cost factors. The 2012 portfolio furthers the identification of projects for advancement based on the criteria utilized in 2011. In addition, it recognizes/recommends action towards resolving major facility condition deficiencies.

The criteria identified projects that were:

- Of high educational priority (DOE Rating)
 - Of efficient construction factors (SDA Rating)
 - Poised to proceed to next appropriate development stage (planning and/or design status)
 - In final validation stages to proceed
 - Review of Site & Environmental Factors
 - Constructability Review
 - Review of Project Budget & Schedule
 - Review of Value Engineering
 - Supportive of standardization
2. Projects addressing high educational priority needs that require further discussion with the District will be pursued through the site visit program to investigate conditions, validate needs and scope most appropriate project. This process will look to resolve any programmatic and/or logistical concerns prior to identification of any specific project for advancement.

2012 Selection Process (continued)

3. Projects that address serious facility deficiencies

The SDA emergent site visit work has revealed many school facilities with deficiencies that will not be remedied through the advancement of isolated emergent projects. To address this, a review of potential projects that would address serious facility deficiencies was conducted utilizing the DOE Facility Ranking and results from the 2011 Potential Emergent Projects Review, including:

- DOE Facilities Ratings
- District supplied data from the 2011 Potential Emergent Projects Review
- DOE/SDA categorization of issues as Capital Maintenance conditions
- Review of previous capital projects transmitted by the DOE to the SDA, including emergent projects, grants and/or health and safety work completed at the school as well as District plans for future use of existing facilities.

SDA Capital Program 2012 Advancement Portfolio

Section 3: Summary

SDA's 2012 Project Portfolio:

- Continue to Advance Construction activities on Projects approved in the 2011 Portfolio
- 8 2012 Portfolio Projects to advance into Pre-Development or Construction, inclusive of alternative delivery methods, in 2012 to address educational priority need in Districts
- Conduct District/DOE/SDA Working Group review of District needs in 7 Districts
- 5 2012 Portfolio Projects for detailed scope development toward advancement to address serious facility condition deficiencies
- Continue Site Visit Program to Investigate Conditions & Validate Needs
- Complete Active Construction Projects in SDA Districts